

Travel Maximum 17 metres

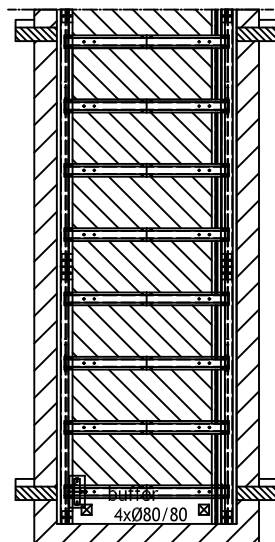

Typical List of builders work

1. Provide electrical supply at the top level adjacent to our control panel in the form of a 415v, 3ph, 50hz 5 wire supply protected by a 16amp Motor Rated MCB, together with a 230v spur.
2. Machine room access by ladder
3. Shaft enclosure to fixed after installation of lift, else leave front wall down at all levels
4. Clad shaft following installation of the lift. Cladding to be in accordance with building control requirements.
5. Structure shall not carry buildings forces. Structure to be fixed to building fabric in the pit at each level served and at the top.
6. Provide 1000 kg SWL lifting eye central above shaft
7. Temperature in MR room shall be between +5 ° to 40 ° constantly
8. Provide scaffold tower for installation, details to be confirmed at contract stage.
9. Provide storage space on site and assistance to off load.
10. Note lift car delivered and installed in one section access space required
11. Provide barriers at each floor to guard against fall hazards
12. Provide 110v temp. lighting & power
13. Protect building fabric during egress of materials, disposal of packaging
14. Provide assistance with off loading and distribution of materials.
15. Provide an analogue BT telephone line terminated adjacent to the control panel.
16. If fire rating is required the front wall must be constructed in accordance with EN81-58.

Notes

1. Machinery Directive Compliant.
2. For goods only and for goods with one trainer operator.
3. Lift car fitted with key activated in car constant pressure controls.
4. For authorised users only.
5. Car protection by light curtain and flush well lining on the entrance sides.
6. 750kg or 1000kg rated load options.
7. Car width and depth dimension in increments of 25.
8. Car height dimension in increments of 100.
9. Not to be used as a general passenger/goods lift.
10. Lift car fitted with an Autodialer for connection to a rescue service.
11. All finishes galvanised.
12. Lift mechanical and electrical loadings advised at contract stage.

Issued for information only

BY	DATE	ISSUE	MODIFICATION	CHECKED
TMP	14.12.18	B	Redrawn	

ATTENDED USE GOODS LIFT WITH DOUBLE SWING HINGE DOORS THROUGH CAR OPENING

NICHE LIFTS Ltd		DRAWN BY	DATE	CHECKED	SCALE
Do not scale this drawing. All dimensions in millimetres		TMP	6.9.12		NTS
		DRAWING NUMBER		1524/B	