

2.5kn PULL OUT LOADS FROM MAST AT EACH FLOOR (OR A MAXIMUM PITCH OF 4000 MM) ABOVE THE BOTTOM FLOOR. SEE DETAIL BELOW

F=18KN PRESSURE =87KN/M2 APPLIED TO AREA "A". SEE DETAIL BELOW

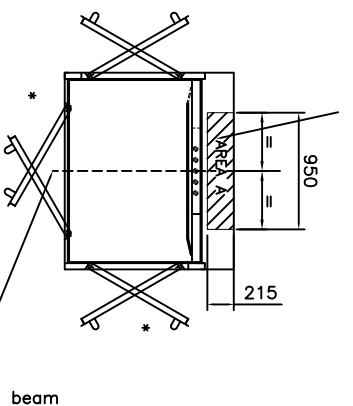
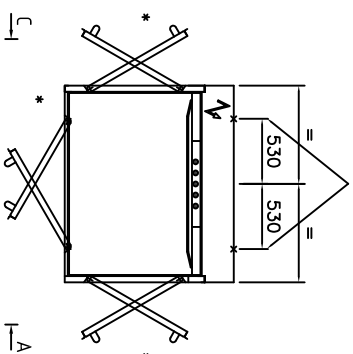
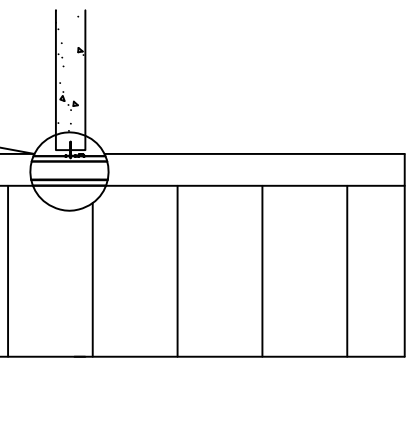

SUPPORTING FRAME FIXING DIMENSIONS

POSITION OF MAST

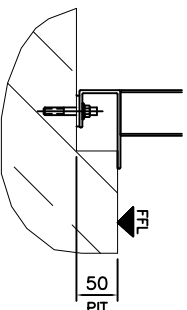
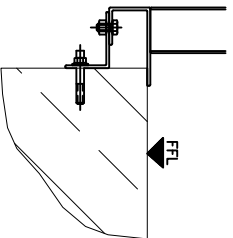

FIXING OF DOOR FRAME AT UPPER LEVEL TO SHAFT WALL OR SLAB

FIXING OF DOOR FRAME AT THE BOTTOM FLOOR WITH PIT \*

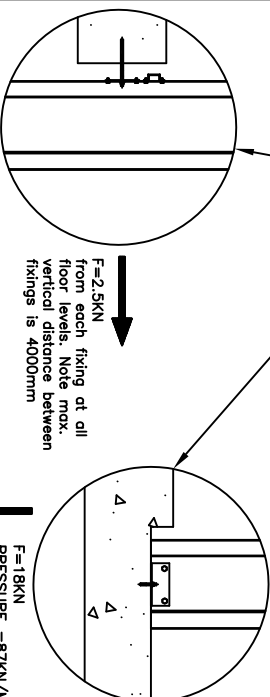

SUPPORT FRAME FIXING AND LOADS

SCHEDULE OF WORKS BY OTHERS

1. Provide a base the same size as the lift shaft capable of carrying the loads as indicated on our drawings. Base to be painted with oil based paint. Note the base is visible when the platform is at the upper levels.
  2. Provide a 50 mm deep pit.
  3. Ensure that the structure fixing points at all floors can withstand the loads as indicated on our drawings.
  4. Provide a well opening as shown on our drawings with nosings at each level for door frame fixing.
  5. Provide a 415v, three phase, 16 amp RCD protected supply terminated in a fused isolator at the top floor 1.8 m from FFL above our control panel. Note the isolator must be capable of being locked in the off position.
  6. Provide a 240v, single phase, 20 amp RCD protected supply terminated in a fused isolator at the top floor 1.8 m from FFL above our control panel. Note the isolator must be capable of being locked in the off position.
- NOTE: If the supply is temporary a chargeable return visit will be required to carryout the final commissioning. If the temporary supply is provided by a generator the should be rated at 20KVA, with the supply cable terminated in the permanent isolator as above.
7. Provide a socket outlet near to the lift for service purposes.
  8. Provide a lifting beam directly above the lift enclosure with a SWL of 500 kg.
  9. Provide a clear access route for the equipment during installation.
  10. Provide protection to the building finishes during egress of the materials.
  11. Provide 110v task lighting in the installation area if required.
  12. Provide barriers if required at each floor to guard against fall hazards.
  13. Provide a finished ceiling above the shaft enclosure together with a light fitting to ensure 50 lux lighting level on the platform (note required if Niche Lifts are to provide a shaft enclosure ceiling)
  14. Provide a BT telephone line point at the top floor adjacent to the isolator for the platform emergency telephone.
  15. Make good the lift enclosure to the building fabric as required.
  16. Provide a tower scaffold to enable the engineer to fix the mast to the building fabric.
  17. Provide FFL datum at each door opening.
  18. Provide structural openings at each level served full width of the shaft 2300 mm high to allow for door frame installation.
  19. Fire clad the lift shaft enclosure up to our door panels at each level to maintain the necessary fire rating. Please note the fire cladding must not be drill fixed to our enclosure.
  20. Provide assistance in off loading and distribution of equipment.

BY	DATE	ISSUE	MODIFICATION	CHECKED
TMP	1.11.06	2	Loading detail changed	
TMP	25.1.10	3	Builders work notes updated	
TMP	7.5.10	4	Builders work notes updated	
TMP	23.6.10	5	Builders work notes updated	

NICHE PLATFORM LIFT TYPICAL FIXING/LOADING & BUILDERS WORK DETAIL

NICHE LIFTS LTD 82 St Georges Road West, Bromley, Kent, BR1 2NP Tel: 020 8998 2882 Fax: 020 9487 1044  
e-mail: sales@nichelifts.co.uk Web Site: www.nichelifts.co.uk

NICHE LIFTS LTD		DRAWN BY	DATE	CHECKED	SCALE
Do not scale this drawing. All dimensions in millimetres		TMP	25.7.06	FMP	NTS
		DRAWING NUMBER			

1122/5